

# Legacy of the North Carolina Face Jug Exhibit

July 29-August 9

Burroughs Welcome Gallery

Jenkins Fine Arts Center

East Carolina University



Curated by Jody Stouffer, ECU MAEd in Art Ed. Final Project

Primary Evaluator: Dr. Robbie Quinn

Secondary Evaluator: Tom Braswell, Gray Gallery Director

## Table of Contents

- Initial Planning Sheet
- Promotional Poster and Mailing Card
- Artwork Loan Agreement
- Press Release
- Organizations and Agencies that received promotional materials
- Newspaper articles promoting the exhibit
- Email correspondence from agencies and museums
- Websites promoting the exhibit
- Central Piedmont / Seagrove Image Catalog
- Catawba Valley Region Image Catalog
- Mountain Region Image Catalog
- Lee County High School Student Work Image Catalog
- Exhibit Inventory
- Burroughs Wellcome Gallery Planning Schematic
- Images of the Legacy of the North Carolina Face Jug Exhibit
- Images of the Reception
- Informational fliers given to me by potters
- Legacy of the North Carolina Face Jug Exhibit Final Thoughts

AV Smith \$120  
Initial Planning Sheet

Jeff  
Spire's

Face Jug Final Project Collection

Central Piedmont / Seagrove

- ☒ AV Smith - 919-258-3248 - Broadway
- ☐ Crystal King - Crystal King 2475 N Carolina 705 Seagrove, NC 27341 (336) 879-6990
- ☐ Sid Luck - 336.879.3261, Seagrove
- ☐ Jason Luck - Seagrove
- ☐ Matt Luck - Seagrove
- ☒ Terry King w (336) 381-3090 h (335) 381-3732 - Seagrove
- ☐ Anna King - Seagrove
- ☐ Sandy Cole (919) 774-1575 call back 5-8-2013 Sanford
- ☐ Kevin Brown Sanford
- ☒ ML Owens (910) 464-3553 - Boyd Owens - Seagrove
- ☒ Stacy Lambert 336-633-8090 7064 Harperglenn road, Clemmons Tanglewood exit

Catawba River Valley

- ☐ Burlon Craig - Crystal King Don Craig, Dwayne Craig
- ☒ Charlie Lisk - 704-462-2881, 7386 west nc 10 highway Vale
- ☒ Albert Hodge 704.462.1411 8112 Hwy 10 West Vale, NC 28168 - Deanna
- ☒ Kim Ellington 7110 W. Hwy 10 • Vale, NC 28168 • 704-462-2067
- ☐ Joe Reinhardt
- ☒ Steve Abee - 2349 Mystery Trail Lane, Lenoir, NC 28645-7321- Deanna
- ☒ Walter Fleming - 704-872-7568 1158 scotts creek road, Statesville 28625 called and left message 5-9-13
- ☒ Hal Dedmond 537-1 Belwood Lawndale Rd, Lawndale, NC 28090 1.704.538.1057 4pm cell 704-477-0226
- ☒ Jeff Young - Vale, N.C. <http://www.jeffyoungpottery.com/>
- ☒ Gary Mitchell - 5303 Springs Rd Conover, North Carolina 28613 - sent email 5-9-13 828 256-8358
- ☐ Michel Bayne 980-241-0493 4109 Ritchie Road, Lincolnton, NC 28092 [http://www.michelbayne.com/About\\_Me.html](http://www.michelbayne.com/About_Me.html)
- ☒ Richard Kalk 704-748-9085

Mountain Region

- ☒ Charlie Brown - 2398 Hendersonville Highway in Arden, NC (828) 684-2901 The brown family 11<sup>th</sup> generation of face jug potters

☒ Mike Ball

# Legacy of the North Carolina Face Jug

Steve Abee

Michel Bayne

Charlie Brown & the Brown Family

Sandy Cole & Kevin Brown

Burlon Craig

Hal Dedmond

Kim Ellington

Walter Fleming

Albert Hodge

Richard Kale

Crystal King

Terri & Anna King

Stacy Lambert

Charlie Lisk

Sid Luck & the Luck Family

Gary Mitchell

ML Owens

Joe Reinhardt

AV Smith

Jeff Young

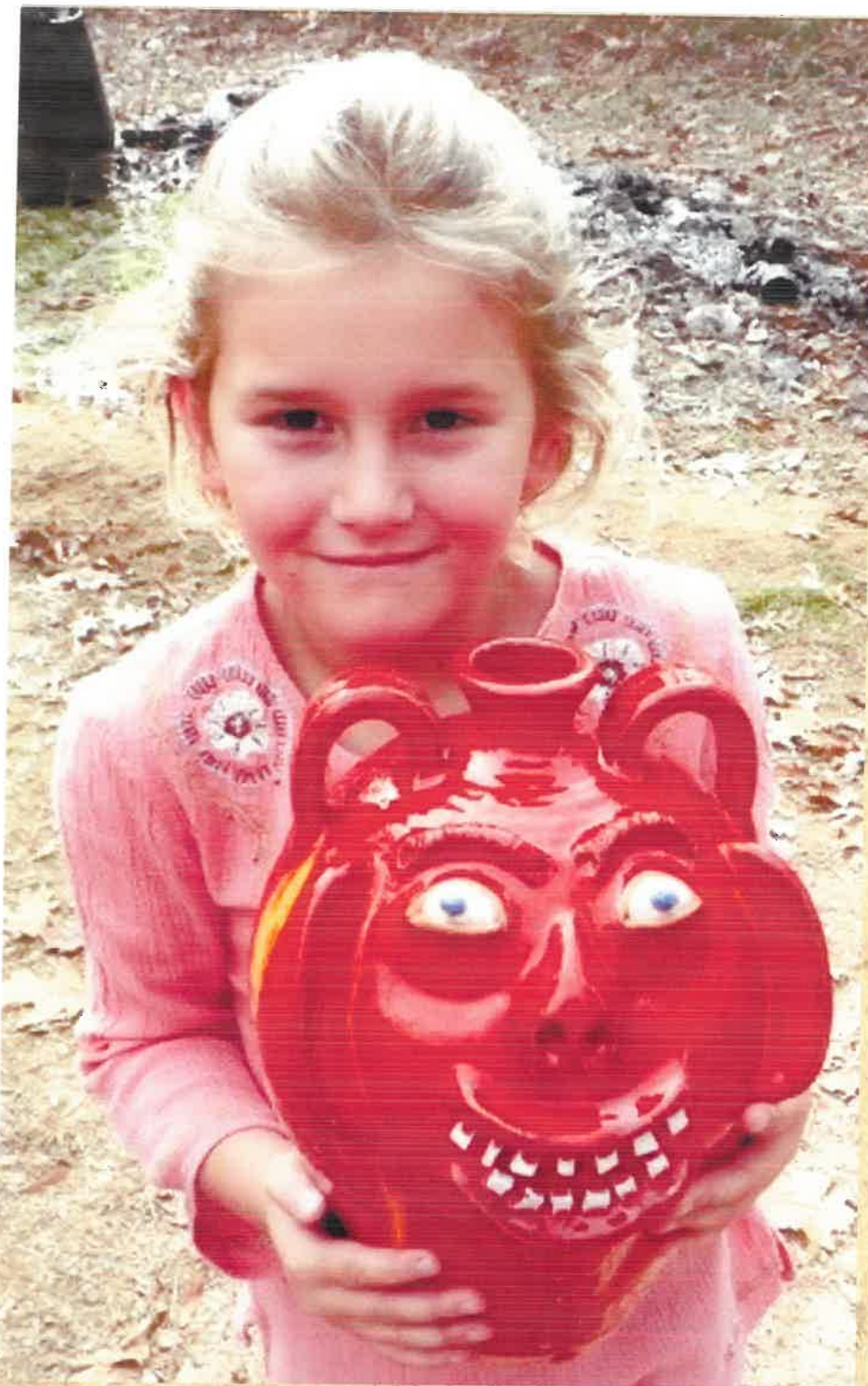

**Burroughs Wellcome Gallery - Jenkins Fine Arts Center**

# East Carolina University

**July 29 - Aug. 9, 2013**

**Mon.-Fri. 8-5pm**

**RECEPTION**

**FRIDAY, AUGUST 2, 2013**

**5-7pm**



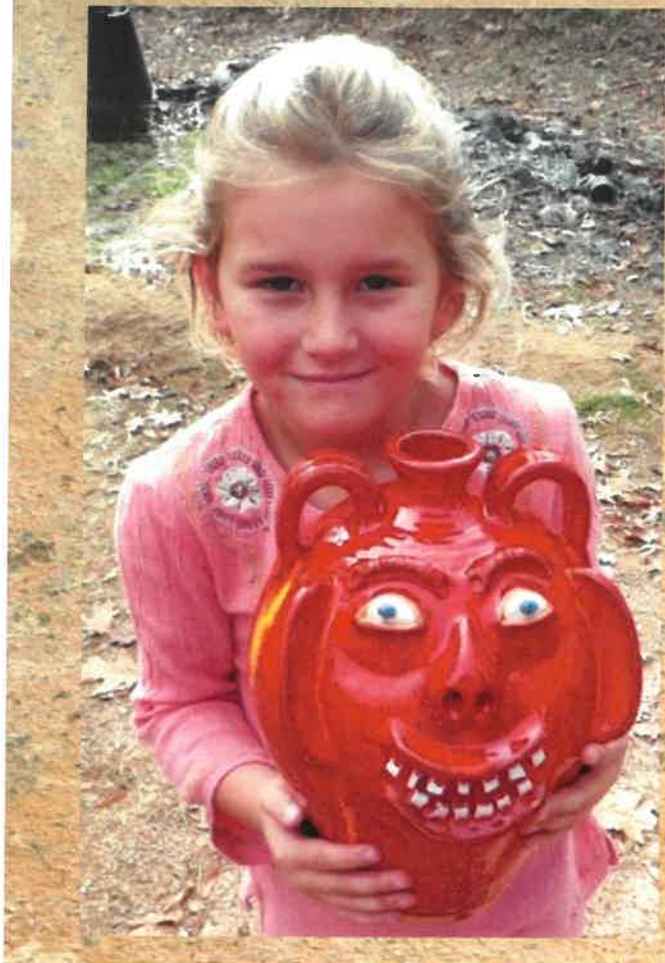

# Legacy of the North Carolina Face Jug

Steve Abee • Michel Bayne  
 Charlie Brown & the Brown Family  
 Sandy Cole & Kevin Brown • Burlon Craig  
 Hal Dedmond • Kim Ellington • Walter Fleming  
 Albert Hodge • Richard Kale • Crystal King  
 Terri & Anna King • Stacy Lambert • Charlie Lisk  
 Sid Luck & the Luck Family • Gary Mitchell  
 ML Owens • Joe Reinhardt • AV Smith • Jeff Young

**Burroughs Wellcome Gallery  
 Jenkins Fine Arts Center**

## **East Carolina University**

July 29 - Aug. 9, 2013 Mon.-Fri. 8-5pm

**RECEPTION FRIDAY, AUGUST 2, 2013 5-7pm**

# Legacy of the North Carolina Face Jug

This exhibit features 26 of North Carolina's most renowned face jug potters and is being presented by MAED in Art Education candidate Jody Stouffer as his final culminating project.

The Burroughs Wellcome Gallery is located beside the Wellington B. Gray Gallery in the Jenkins Fine Arts Center off of Fifth and Jarvis Streets on the campus of East Carolina University.



**Burroughs Wellcome Gallery  
 Jenkins Fine Arts Center**

July 29 - Aug. 9, 2013

Mon.-Fri. 8-5pm

## **East Carolina University**

**RECEPTION FRIDAY, AUGUST 2, 2013 5-7pm**

**Phone:** (252) 328-1287



Burroughs Wellcome Gallery  
 School of Art and Design  
 Mail Stop 502  
 East Carolina University  
 Greenville, NC 27858-4353

**BURROUGHS WELLCOME ART GALLERY – JENKINS FINE ARTS CENTER  
EAST CAROLINA UNIVERSITY**

**ARTWORK LOAN AGREEMENT**

**Curator: Jody Stouffer - (828) 320-9838**

**EXHIBITION DESCRIPTION**

Title: Legacy of the North Carolina Face Jug

Time period for exhibition: July 29 – August 9, 2013

Date and time for reception: Friday August 2, 2013 5-7pm

Number of works, description, date created, dimensions and value:

1. \_\_\_\_\_
2. \_\_\_\_\_
3. \_\_\_\_\_
4. \_\_\_\_\_
5. \_\_\_\_\_

**PREPARATION**

Exhibition inventory/Insurance Values: A legible list of the works to be exhibited including: artist, title, medium, date created, dimensions and insurance values will be submitted to the Burroughs Wellcome Gallery Director prior to the exhibit.

**TRANSPORTATION**

Works will be properly crated by the artist or the artist will observe the curator doing so to their satisfaction to prevent damage during transit. Works will be repacked and returned in the same manner in which they are sent at the completion of the exhibit.

**GOVERNING CONDITIONS**

Commitment: No work will be removed from the exhibition during the exhibition period, except in case of emergencies including but not limited to damage to the art or the building that requires removal of the artwork to prevent further damage.

Care: The curator, Jody Stouffer, will individually install and dismantle the exhibition. The Burroughs Wellcome Gallery will provide professional storage, and display conditions for the works in the exhibition. This includes insurance coverage for the values provided by East Carolina University under the same fine arts insurance policy as for the Gray Gallery collection.

The Burroughs Wellcome Gallery agrees to an exhibition of the work belonging to artist signed below under the conditions specified on this agreement. I have read and agree to the above conditions and certify that I am authorized to enter into this agreement.

\_\_\_\_\_  
Jody Stouffer, Curator for the "Legacy of the Face Jug" Exhibit

\_\_\_\_\_  
Date  
\_\_\_\_\_  
Date

## Press Release

From its creation in the mid 1800's until present day, the southern potter has helped the mystical face jug survive and adapt as not only an original, utilitarian, artistic expression of its creator but as an icon in southern folk art. The Burroughs Wellcome Gallery in the Jenkins Fine Arts Center on the campus of East Carolina University is pleased to present *"Legacy of the North Carolina Face Jug"* July 29 through August 9 2013 with a reception to be held Friday, August 2 from 5-7pm. This exhibit will be a celebration of the Tarheel state's most renowned face jug potters and face jug pottery families, featuring pieces from 31 different face jug creators. A collection of their work has never been displayed together at one time until this exhibition. This exhibition is being curated by Jody Stouffer, East Carolina University MAED in Art Education Candidate, as his final culminating project. The Burroughs Wellcome Gallery is open Monday through Friday from 8-5pm. For more information call (252) 328-1287.

Promotional materials were sent to the following Organizations and Agencies

Ackland Museum of Art  
Albert Hodge Pottery  
AmericanTowns.com – Pitt County, NC  
Antique Trader.com – NC Folk Art Museums  
Appalachian Heritage Magazine  
Appalachian Folk Art Center, Asheville, NC  
Art Avenue, Greenville, NC  
Asheville Art Museum  
AV Smith Pottery, Broadway, NC  
Brian Dedmond – Co-Author of “Valley Ablaze” and Catawba Valley Pottery Collector, Lincolnton, NC  
Cameron Art Museum – Wilmington, NC  
Cape Fear Tattoo, Greenville, NC  
Carolina Artist’s Colony, Sanford, NC  
Charlie Lisk Pottery, Vale, NC  
Charlotte Folk Society Pottery  
City Art Gallery, Greenville, NC  
Cole Pottery, Sanford, NC  
Crystal King Pottery, Seagrove, NC  
Cubbie’s Restaurant, Greenville, NC  
Daily Advance, Elizabeth City Newspaper  
Daily Reflector, Pitt County Newspaper  
Dawn Crouse, Co-Author of “Valley Ablaze” and Catawba Valley Pottery collector, Lincolnton, NC  
East Carolina University Events Calendar  
East Carolina University website  
Family of Carmen O’Quinn  
Family of Micaela Schlott  
Family of Sarah Batten  
Family of Elijah West  
Family of Samantha Sillaman  
Farmville Community Arts Council  
Folklife Program N.C. Arts Council  
FrameMakers, Greenville, NC  
Greenville Museum of Art  
G-VEGAS Magazine, Greenville, NC  
Hal Dedmond Pottery, Lawndale, NC  
Henderson Dispatch, Henderson, NC  
Herald Sun, Durham, NC  
Highpoint Enterprise, Highpoint, NC  
Ink Stone Gallery, Greenville, NC  
ITeach, Greenville, NC  
Invitations sent to past ECU Master’s degree professors  
Jeff Young Pottery  
Jenkins Fine Arts Center, ECU Campus  
Jody Stouffer Facebook page  
Kim Ellington Pottery, Vale, NC  
King Pottery, Seagrove, NC  
Lee County Arts Council  
Lee County High School Faculty



Lee County High School website  
Lee County Schools website  
Luck's Wares, Seagrove, NC  
Michel Bayne Pottery, Vale, NC  
MINT Museum of Charlotte, Joel Smeltzer, School Programs Coordinator  
MINT Museum of Craft and Design  
Murfeesboro Historical Society, Brady C. Jefcoat Museum  
News & Observer, Raleigh, NC  
News & Record Newspaper, Greensboro, NC  
North Carolina Art Education Association Facebook page  
North Carolina Exploring Cultural Heritage Online  
North Carolina Folklore Journal  
North Carolina Folk Art Society  
North Carolina Pottery Center, Seagrove, NC  
Our State Magazine  
Outer Banks.org July Events  
Owens Original Pottery, Seagrove, NC  
Region 1 NCAEA members  
Rocky Mount Telegram Newspaper  
Sanford Brush & Palette Club  
Sanford Herald Newspaper, Sanford, NC  
Southern Highland Craft Guild  
Stacy Lambert Pottery, Clemmons, NC  
Strickland Art Gallery, Greenville, NC  
Sun Journal Newspaper, New Bern, NC  
TheArtsConnectionNC.com  
The Art room Gallery & Studio, Greenville, NC  
The Daily Southerner Newspaper, Edgecome County  
The Hobby Horse, Greenville, NC  
The Scollery Coffee House and Creamery, Greenville, NC  
Things to do.com North Carolina  
Triple Creek Pottery – Walter Fleming, Statesville, NC  
Uptowngreenville.com  
Washington Daily News  
Westmore Family Restaurant, Seagrove, NC



## LCHS students exhibit pottery at East Carolina University

**SPECIAL TO THE HERALD**

SANFORD — From its creation in the mid 1800s until present day, the southern potter has helped the mystical face jug survive and adapt as not only an original, utilitarian, artistic expression of its creator, but as an icon in southern folk art.

Lee County High School art educator and East Carolina University Master's degree candidate Jody Stouffer provides an in-depth look into the world of face jugs and shows how the legacy of this traditional southern folk art is being kept alive in the art classroom in his master's degree final project "Legacy of the North Carolina Face Jug." This exhibit will be a celebration of the Tar Heel state's most renowned face jug potters and face jug pottery families, featuring pieces from 31 different face jug creators. A collection of their work has



never been displayed together at one time until this exhibition.

Several current and past Lee County High School pottery students will be exhibiting their creations alongside the North Carolina face jug masters in his exhibit. Students exhibiting their work include Sara

Smith, Micaela Schlott, Sarah Batten, Samantha Sillaman, Elijah West, Daniela Ocampo and Carmen O'Quinn. The exhibit is being presented in the Burroughs Wellcome Gallery in the Jenkins Fine Arts Center on the campus of East Carolina University and will run July

29 through Aug. 9 with a reception to be held Friday, Aug. 2, from 5 to 7 p.m. LCHS student Chris McIntyre will be catering the reception. The Burroughs Wellcome Gallery is open Monday through Friday from 8 to 5 p.m. For more information, call (252) 328-1287.

## COMMUNITY CALENDAR

## TODAY

■ The 2013 Temple Theatre Summer Youth Conservatory will present "Ella" at 2 p.m. at 120 Carthage St., Sanford. Tickets are \$6 for children, \$12 for adults. To order tickets or learn more, visit [www.templeshows.com](http://www.templeshows.com) or call the box office at (919) 774-4155 Monday through Friday from 2-6 p.m.

■ The Rooster's wife will present multi-instrumentalist Tim Carter, who will be joined by Nashville veterans Tim May, Barbara Lamb and Matt Flinner, at 6 p.m. (doors open) in the listening room of Poplar Knight Spot — 114 Knight St. in downtown Aberdeen. The venue seats 110, with additional seating under the awning and under the stars. Tickets may be purchased online at [theroosterswife.org](http://theroosterswife.org), or at the door if still available.

## MONDAY

■ Bob Bridwell, director of Sanford's Community Planning & Development Department, will speak with host Lil Barrett about the upcoming bond referendum on WDSG radio from 10:30-11 a.m. Listeners can hear the program at 107.9 FM or live stream from <http://www.wdsg-fm.com>.

■ The Burroughs Wellcome Gallery will present "Legacy of the North Carolina Face Jug" today through Aug. 9, with a reception to be held Friday, Aug. 2, from 5-7 p.m., in the Jenkins Fine Arts Center on the campus of East Carolina University. This exhibit will be a celebration of the Tarheel state's most renowned face jug potters and face jug pottery families, featuring pieces from 31 different face jug creators. A collection of their work has never been displayed together at one time until this exhibition, which is being curated by Jody Stouffer, East Carolina University, candidate for a master of arts degree in (art) education, as his final culminating project. The Burroughs Wellcome Gallery is open Monday through Friday from 8-5 p.m. For more information call (252) 328-1287.

# LCHS teacher curates exhibit on face jugs

BY WILL DORAN

WDORAN@SANFORDHERALD.COM

SANFORD — One local teacher has been spending his summer curating a one-of-a-kind art exhibit at East Carolina University, as a capstone to his master's degree in education.

Jody Stouffer, an art instructor at Lee County High School, researched the sometimes scary, sometimes silly and always odd North Carolina face jug, collaborating with potters and collectors to put together what the university says is the first time such a large and eclectic exhibition of the jugs has been put together.

Face jugs are decorative ceramics which have — what else? — faces molded into them

SEE JUGS/PAGE A12

A12 / Sunday, August 4, 2013

## JUGS

FROM THE FRONT PAGE

before being fired in a kiln. The faces are cartoonish, bordering on fantastical or surreal, and Stouffer said they can sell for anywhere from \$100 to \$3,000 dollars.

"They're becoming popular now among pottery collectors, almost like baseball cards," he said. "... They're all hand-made and every (artist) has a different style, so no two are alike."

But Stouffer — who is an expert on the topic; Charlotte's Mint Museum of art uses a 53-page lesson plan and presentation from him and fellow Lee Senior teacher Brian Wohleben to teach people how to make face jugs themselves — said that despite burgeoning popularity and longstanding traditions, like one family in Western North Carolina who have been making the jugs for 11 generations, no one really knows a lot about the exact origins of the face jug.

"I think what helped it some is the end of pottery as utilitarian wares," he said, adding that the distinctive style began in South Carolina before spreading to Georgia and North Carolina. "Potters still needed people to have a reason to buy their wares, so they made them unique and did things to make people still want them. ... A lot of them don't have a theme. They're just an ugly face. One potter told me the uglier the face, the better."

Most of North Carolina's current

face jug artists live in the western parts of the state, especially around Hickory, he said, although there is one artist from Broadway, A.V. Smith, featured in the exhibit.

Robert Quinn, an associate professor of art education at ECU, wrote in an email that the school is pleased to have Stouffer's collection of the jugs.

**Most of North Carolina's current face jug artists live in the western parts of the state, especially around Hickory, he said, although there is one artist from Broadway, A.V. Smith, featured in the exhibit.**

"From its creation in the mid 1800's until present day, the southern potter has helped the mystical face jug survive and adapt as not only an original, utilitarian, artistic expression of its creator but as an icon in southern folk art," he wrote. "... This exhibit will be a celebration of the Tar Heel State's most renowned face jug potters featuring pieces from 26 different face jug creators. A collection of their work has never been displayed together at one time until this exhibition."

Stouffer added it's not all just about documenting past successes and established artists.

"The connection is how I'm keeping the tradition alive by teaching how to make face jugs in the classroom," he said. "There's a whole collection in the exhibit of jugs made by Lee County High School students from the past three years. ... There are some pieces students have done that I think are just as strong as what the professionals are doing. It's a privilege to be able to show their work — I just wish we had more venues here in Sanford."

The exhibit will be up until Friday at ECU's Burroughs Wellcome Gallery. It's open 8 a.m. to 5 p.m. on weekdays. For more information, call (252) 328-1287.





Jody Stouffer &lt;jmstouffer@gmail.com&gt;

---

**Event Request**

5 messages

---

**The Arts Connection** <theartsconnectionnc@gmail.com>  
To: jmstouffer@gmail.com

Wed, Jun 12, 2013 at 9:21 AM

Greetings Jody,

We received your Events Request regarding the ECU Grad School Exhibition.  
Please reply with the dates of the exhibit duration, any opening or closing reception date,  
and the specific gallery location where the works will be/are on display.  
We would be glad to post it on The Arts Connection website.

Thanks!

**Colleen Simons**

**The Arts Connection NC**  
817 Dickinson Avenue  
Greenville, NC 27834  
colleensimons@embarqmail.com  
w: 252.561.7980  
c: 252.258.8542  
www.theartsconnectionnc.com

*"The aim of art is to represent not the outward appearance of things,  
but their inward significance."  
~Aristotle*

---

**Jody Stouffer** <jmstouffer@gmail.com>  
To: The Arts Connection <theartsconnectionnc@gmail.com>

Wed, Jun 12, 2013 at 2:00 PM

Dear Colleen,

Thank you for helping me to promote this exhibition. I am a MAED in Art Education student at East Carolina University and this exhibit is my final culminating project. It is titled "Legacy of the North Carolina Face Jug" and will run July 29-Aug. 9 at the Burroughs Wellcome Gallery in the Jenkins Fine Arts Center on the campus of East Carolina University. This exhibit will feature the works of 26 of the Tarheel states most renowned face jug potters. I have attached a press release for this event and also have mini posters and mailing post cards.

If you feel you could display a mini poster or use some of the mailing post cards, I would be happy to drop them off or mail them to you. If you need more information, please feel free to contact me.

Thank you again for helping me to promote this,

Jody Stouffer

[Quoted text hidden]



Jody Stouffer &lt;jmstouffer@gmail.com&gt;

---

**Re: Contact form submission from AAM Website**

2 messages

---

**Laila Boggs** <LBoggs@ashevilleart.org>  
To: Jody Stouffer <jmstouffer@gmail.com>

Wed, Jun 12, 2013 at 6:21 PM

hi Jody,

If you'd like to send a handful of postcards, I can put them in the museums library. ill forward the info on to other staff members as well.

thanks, and good luck!

best,  
Laila

laila alamiri  
4235790902  
bluelikevision@gmail.com

On Jun 12, 2013, at 5:14 PM, "Jody Stouffer" <jmstouffer@gmail.com> wrote:

&gt;

&gt; You have received a contact form submission on Asheville Art Museum. The contact details are listed below.

&gt;

&gt; Name: Jody Stouffer

&gt; E-Mail: jmstouffer@gmail.com

&gt;

&gt; Comments: Dear Ms. Boggs,

&gt; My name is Jody Stouffer and I am a MAED in Art Education student at East Carolina University. I am presenting my final culminating project, "Legacy of the North Carolina Face Jug" July 29-Aug. 9 at the Burroughs Wellcome Gallery in the Jenkins Fine Arts Center on the campus of East Carolina University. This exhibit will feature the works of 26 of the Tarheel states most renowned face jug potters. I have a press release available for this event that I can send via e-mail. I also have mini posters and mailing post cards

&gt;

&gt; Any promotion of this exhibit by your museum would be greatly appreciated. If you feel you could display a mini poster or use some of the mailing post cards, I would be happy to drop them off or mail them to you. If you need more information, please feel free to contact me.

&gt;

&gt; Thank you for your time,

&gt; Jody Stouffer

&gt;

&gt;

> This mail is sent via contact form on Asheville Art Museum <http://www.ashevilleart.org/connect/contact/>

&gt;

&gt; Form info: 75.89.252.155

&gt;

---

**Jody Stouffer** <jmstouffer@gmail.com>  
To: Laila Boggs <LBoggs@ashevilleart.org>

Mon, Jun 24, 2013 at 7:48 AM

---

**2 attachments** **Newspaper and magazine promo.docx**  
14K **Face Jug Exhibit Poster Final.pdf**  
578K

---

**The Arts Connection** <theartsconnectionnc@gmail.com>

Thu, Jun 13, 2013 at 9:36 AM

To: Jody Stouffer &lt;jmstouffer@gmail.com&gt;

Jody,

Thank you for supplying the information to promote your event. The exhibit has been placed on the Senior Show website page to announce your culminating project. I'm thrilled at the topic of "The North Carolina Face Jug". Having hailed from the ceramic cultural center of Sanford NC a few years back as, it's great that you are curating a display of 26 unique Tarheel jug creators. I will be placing the event on my own calendar as well.

**Colleen Simons****The Arts Connection NC**

817 Dickinson Avenue

Greenville, NC 27834

colleensimons@embarqmail.com

w: 252.561.7980

c: 252.258.8542

www.theartsconnectionnc.com

*"The aim of art is to represent not the outward appearance of things,  
but their inward significance."*

*~Aristotle*

[Quoted text hidden]

[Quoted text hidden]

&lt;Newspaper and magazine promo.docx&gt;&lt;Face Jug Exhibit Poster Final.pdf&gt;

**Colleen Simons****The Arts Connection NC**

817 Dickinson Avenue

Greenville, NC 27834

colleensimons@embarqmail.com

w: 252.561.7980

c: 252.258.8542

www.theartsconnectionnc.com

*"The aim of art is to represent not the outward appearance of things,  
but their inward significance."*

*~Aristotle*

---

**Jody Stouffer** <jmstouffer@gmail.com>

Thu, Jun 13, 2013 at 1:34 PM

To: The Arts Connection &lt;theartsconnectionnc@gmail.com&gt;



Jody Stouffer <jmstouffer@gmail.com>

---

**RE: A message from april@craftguild.org for Public Relations, PO BOX 9545, Asheville, NC 28815 - (828)298-7928 .**

2 messages

---

**April Nance** <april@craftguild.org>  
To: jmstouffer@gmail.com

Thu, Jun 13, 2013 at 11:14 AM

Dear Jody,  
Congratulations on your project. You can send me some postcards (50 - 100) and I will be glad to have them on a table of brochures during our Craft Fair which is July 18 - 21 at the US Cellular Center in downtown Asheville. You can mail to the post office box below to my attention.

Thanks for thinking of us,  
April Nance  
Public Relations  
Southern Highland Craft Guild  
PO Box 9545, Asheville NC 28815  
p. 828-298-4263 ext. 309  
f. 828-298-7962  
www.craftguild.org

-----Original Message-----

From: jmstouffer@gmail.com [mailto:jmstouffer@gmail.com]  
Sent: Wednesday, June 12, 2013 4:47 PM  
To: april@craftguild.org  
Subject: A message from april@craftguild.org for Public Relations, PO BOX 9545, Asheville, NC 28815 - (828)298-7928 .

Dear SH Craft Guild,  
My name is Jody Stouffer and I am a MAED in Art Education student at East Carolina University. I am presenting my final culminating project, "Legacy of the North Carolina Face Jug" July 29-Aug. 9 at the Burroughs Wellcome Gallery in the Jenkins Fine Arts Center on the campus of East Carolina University. This exhibit will feature the works of 26 of the Tarheel states most renowned face jug potters. I can email you a press release for this event and also have mini posters and mailing post cards.

Any promotion of this exhibit by your organization would be greatly appreciated. If you feel you could display a mini poster or use some of the mailing post cards, I would be happy to drop them off or mail them to you. If you need more information, please feel free to contact me.

Thank you for your time,  
Jody Stouffer

-----

No virus found in this message.  
Checked by AVG - www.avg.com  
Version: 2012.0.2242 / Virus Database: 3199/5904 - Release Date: 06/12/13

---

**Jody Stouffer** <jmstouffer@gmail.com>

Mon, Jun 24, 2013 at 7:46 AM





Jody Stouffer &lt;jmstouffer@gmail.com&gt;

---

**Legacy of the NC Face Jug Exhibit**2 messages

---

**Jody Stouffer** <jmstouffer@gmail.com>

Fri, Jun 14, 2013 at 5:38 PM

To: info@ncpotterycenter.org

Dear friends at the pottery center,

I came by the Pottery Center today and dropped some information off on my MAED in Art Education final culminating project, "Legacy of the North Carolina Face Jug" July 29-Aug. 9 at the Burroughs Wellcome Gallery in the Jenkins Fine Arts Center on the campus of East Carolina University.

The ladies behind the counter were nice enough to display my poster and put my postcards on display. I was wondering if you would mind listing the event on your "other events" page on the NCPC website.

My exhibit will feature the works of 26 of the Tarheel states most renowned face jug potters. I have attached a press release if you want to copy and paste some of the information. I'm trying to promote this exhibit as much as possible since it is my final project for my Masters degree. If you need more mailing post cards, justt me know, I will be back in the Seagrove area in about two weeks.

Thanks again for helping to promote my event,

Jody Stouffer

**Newspaper and magazine promo.docx**

14K

---

**Lindsey Lambert** <director@ncpotterycenter.org>

Mon, Jun 17, 2013 at 1:02 PM

To: Jody Stouffer &lt;jmstouffer@gmail.com&gt;

Cc: manager@ncpotterycenter.org, Front Desk &lt;info@ncpotterycenter.org&gt;

Hi Jody,

I am the new director here at the Pottery Center. I'm glad you had a good visit to the center this past Friday. Your exhibit sounds like an interesting one. Let me check with Paulette and Nicole here at the center to see what the policy is on such requests. I want to find a way to accommodate your desire for some additional publicity for your exhibit, but I want to make sure of what the current policies are regarding such to determine the best way to go about it.

I/We will be back in touch soon.

I hate I missed meeting you the other day.

Thanks,  
Lindsey

--

Lindsey A. Lambert  
Executive Director, NC Pottery Center

233 East Avenue, Seagrove, NC 27341  
www.ncpotterycenter.org  
336-873-8430



Jody Stouffer &lt;jmstouffer@gmail.com&gt;

---

**Legacy of the NC Face Jug Exhibit,**2 messages

---

**Jody Stouffer** <jmstouffer@gmail.com>

Mon, Jul 1, 2013 at 5:38 PM

To: info@pittcountyarts.org

Dear Friends at the Pitt County Arts Council,

My name is Jody Stouffer and I am a MAED in Art Education student at East Carolina University. I am also on the Board of Directors for the Lee County Arts Council. I stopped by your office today, Monday, July 1 but unfortunately you were closed. I left a promotional card for my Masters degree final culminating project, "Legacy of the North Carolina Face Jug" July 29-Aug. 9 at the Burroughs Wellcome Gallery in the Jenkins Fine Arts Center on the campus of East Carolina University. This exhibit will feature the works of 31 of the Tarheel states most renowned face jug potters. I have attached a press release for this event and advertising flier if you can in any way help me further promote this exhibition.

If you need more information, please feel free to contact me.

Thank you for your time,

Jody Stouffer

---

**2 attachments** **Newspaper and magazine promo.docx**  
14K **Face Jug Exhibit Poster Final.pdf**  
578K

---

**Holly Garriott** <holly@pittcountyarts.org>

Mon, Jul 8, 2013 at 11:36 AM

To: Jody Stouffer &lt;jmstouffer@gmail.com&gt;

Thanks for letting me know about this Jody. We can definitely put up a poster. I would definitely get the press release to the daily reflector, and make sure that Sarah Hooper in the SOAD office posts it on our countywide calendar.

Holly Garriott  
Executive Director  
Pitt County Arts Council at Emerge  
252.551.6947  
404 S. Evans Street  
Greenville, NC 27858  
holly@pittcountyarts.org

[Quoted text hidden]

[Quoted text hidden]



Jody Stouffer &lt;jmstouffer@gmail.com&gt;

---

**Legacy of the NC Face Jug Exhibit**3 messages

---

**Jody Stouffer** <jmstouffer@gmail.com>

Tue, Jul 2, 2013 at 3:12 PM

To: mac4@triad.rr.com

Dear Mr. MacAtee,

My name is Jody Stouffer and I am a MAED in Art Education student at East Carolina University. I received your e-mail from Crystal King, whom I am collaborating with on a face jug book. I am presenting my final culminating project, "Legacy of the North Carolina Face Jug" July 29-Aug. 9 at the Burroughs Wellcome Gallery in the Jenkins Fine Arts Center on the campus of East Carolina University. This exhibit will feature the works of 31 of the Tarheel states most renowned face jug potters. I have attached a press release and mini posters for this event. Crystal thought your group might be interested in this exhibit.

Any promotion of this exhibit by your organization would be greatly appreciated. If you need more information, please feel free to contact me.

Thank you for your time,

Jody Stouffer

---

**2 attachments** **Newspaper and magazine promo.docx**  
14K **Face Jug Exhibit Poster Final.pdf**  
578K

---

**Mac McAtee** <mac4@triad.rr.com>

Tue, Jul 2, 2013 at 3:19 PM

To: Jody Stouffer &lt;jmstouffer@gmail.com&gt;

Howdy Jody,  
I like what you are up to.

I am the web master for the North Carolina Pottery Collectors Guild. I told Crystal that I could put the announcement of the exhibit on the Guild web site if it was desired.

She suggested that I not do that till some time in July. Said she didn't think it would be a problem with you if I did that.

So, if I have your consent, then tell me when you want it to show up there and it will be done.

Regards,  
Mac

[Quoted text hidden]

---

**Mac McAtee** <mac4@triad.rr.com>

Sat, Jul 6, 2013 at 2:15 PM

To: Jody Stouffer &lt;jmstouffer@gmail.com&gt;, crystalking@triad.rr.com

Jody, Crystal,

The color card has been added to the NC Pottery Collectors Guild web site - Events page.

<http://www.ncpotterycollectors.org/>

Regards,

Mac McAtee

On 7/2/2013 3:12 PM, Jody Stouffer wrote:

[Quoted text hidden]





Jody Stouffer &lt;jmstouffer@gmail.com&gt;

---

**ECU Face Jug Exhibit**

2 messages

---

**Jody Stouffer** <jmstouffer@gmail.com>

Mon, Jul 22, 2013 at 9:11 AM

To: aclark@reflector.com

Cc: cspeller@reflector.com, baburns@reflector.com, kgrizzard@reflector.com, jhudson@reflector.com, lhorn@reflector.com

Dear Daily Reflector,

My name is Jody Stouffer and I am a MAED in Art Education student at East Carolina University as well as a columnist for the Sanford Herald in Sanford, NC. I am presenting my Master's degree final culminating project, "Legacy of the North Carolina Face Jug" July 29-Aug. 9 at the Burroughs Wellcome Gallery in the Jenkins Fine Arts Center on the campus of East Carolina University. This exhibit will feature the works of 31 of the Tarheel states most renowned face jug potters. I have attached a press release and mini posters for this event.

Any promotion of this exhibit or listing in upcoming events by your newspaper would be greatly appreciated. If you need more information, please feel free to contact me at jmstouffer@gmail.com or by cell phone at 828-320-9838.

Thank you for your time,

Jody Stouffer

---

**2 attachments****Newspaper and magazine promo.docx**

14K

**Face Jug Exhibit Poster.pdf**

689K

---

**Jane Hudson** <jhudson@reflector.com>

Mon, Jul 22, 2013 at 9:38 AM

To: Jody Stouffer &lt;jmstouffer@gmail.com&gt;

Jody,

Thanks so much for the information about your master's project. I have passed the information along to Natalie Sayewich (nsayewich@reflector.com), who handles our arts covers and our Go! calendar.

Thanks for letting us know about it,

Jane

Jane Hudson  
Features Writer  
The Daily Reflector  
1150 Sugg Parkway  
Greenville, NC 27834  
(252) 329-9577 Office  
(252) 754-8140 Fax  
www.reflector.com



Jody Stouffer &lt;jmstouffer@gmail.com&gt;

---

**ECU Face Jug Exhibit**

2 messages

---

**Jody Stouffer** <jmstouffer@gmail.com>

Mon, Jul 22, 2013 at 9:11 AM

To: aclark@reflector.com

Cc: cspeller@reflector.com, baburns@reflector.com, kgrizzard@reflector.com, jhudson@reflector.com, lhorn@reflector.com

Dear Daily Reflector,

My name is Jody Stouffer and I am a MAED in Art Education student at East Carolina University as well as a columnist for the Sanford Herald in Sanford, NC. I am presenting my Master's degree final culminating project, "Legacy of the North Carolina Face Jug" July 29-Aug. 9 at the Burroughs Wellcome Gallery in the Jenkins Fine Arts Center on the campus of East Carolina University. This exhibit will feature the works of 31 of the Tarheel states most renowned face jug potters. I have attached a press release and mini posters for this event.

Any promotion of this exhibit or listing in upcoming events by your newspaper would be greatly appreciated. If you need more information, please feel free to contact me at jmstouffer@gmail.com or by cell phone at 828-320-9838.

Thank you for your time,

Jody Stouffer

---

**2 attachments** **Newspaper and magazine promo.docx**  
14K **Face Jug Exhibit Poster.pdf**  
689K

---

**Jane Hudson** <jhudson@reflector.com>

Mon, Jul 22, 2013 at 9:38 AM

To: Jody Stouffer &lt;jmstouffer@gmail.com&gt;

Jody,

Thanks so much for the information about your master's project. I have passed the information along to Natalie Sayewich (nsayewich@reflector.com), who handles our arts covers and our Go! calendar.

Thanks for letting us know about it,

Jane

Jane Hudson  
Features Writer  
The Daily Reflector  
1150 Sugg Parkway  
Greenville, NC 27834  
(252) 329-9577 Office  
(252) 754-8140 Fax  
www.reflector.com



Joseph Stouffer <jstouffer.ls@lee.k12.nc.us>

---

## Legacy of the NC Face Jug Exhibit

---

Owens, Caitlin <cowens@newsobserver.com>

Mon, Jul 29, 2013 at 5:25 PM

To: Joseph Stouffer <jstouffer.ls@lee.k12.nc.us>

Hi Jody,

A brief appeared in today's paper, page 3B. Hope it goes well.

Caitlin

On Mon, Jul 29, 2013 at 5:20 PM, Joseph Stouffer <jstouffer.ls@lee.k12.nc.us> wrote:

Caitlyn,

If you are able to write a story or include information in the N&O about the face jug exhibit, would you mind letting me know what day it will be in there. I am not a usual subscriber of the N&O and I would like to include the information as part of my final project portfolio that I will be turning in at the end of my exhibit.

Thanks again,

Jody

On Sun, Jul 28, 2013 at 1:56 PM, Joseph Stouffer <jstouffer.ls@lee.k12.nc.us> wrote:

Caitlyn,

I attached the news release, a few pics and the promo poster, readers can also read more on the ecu website at [www.ecu.edu](http://www.ecu.edu)

Thanks again for helping to promote my exhibit,

Jody

---

E-mail correspondence to and from this sender may be subject to the North Carolina Public Records Law and may be disclosed to third parties.

--

Caitlin Owens

Reporter

The News & Observer / newsobserver.com

215 S. McDowell St, Raleigh, NC 27602

Office: 919-829-4567

Cell: 813-817-5811

- Drivers Education
- EVAAS Login Page
- Lunch Menus
- Media Center/Research Tools
- Rosetta Stone
- Sub Finder
- Technology Assistance

## LCHS Students Exhibit Pottery at East Carolina University July 29 - August 10

From its creation in the mid 1800's until present day, the southern potter has helped the mystical face jug survive and adapt as not only an original, utilitarian, artistic expression of its creator but as an icon in southern folk art.



Lee County High School art educator and East Carolina University Master's degree candidate, Jody Stouffer, provides an in depth look into the world of face jugs and shows how the legacy of this traditional southern folk art is being kept alive in the art classroom in his master's degree final project "Legacy of the North Carolina Face Jug".

This exhibit will be a celebration of the Tarheel state's most renowned face jug potters and face jug pottery families, featuring pieces from 31 different face jug creators. A collection of their work has never been displayed together at one time until this exhibition.

Several current and past Lee County High School pottery students will be exhibiting their creations alongside the North Carolina face jug masters in his exhibit. Students exhibiting their work include Sara Smith, Micaela Schott, Sarah Batten, Samantha Sillman, Elijah West, Daniela Ocampo and Carmen O'Quinn.

The exhibit is being presented in the Burroughs Wellcome Gallery in the Jenkins Fine Arts Center on the campus of East Carolina University and will run July 29 through August 9 2013 with a reception to be held Friday, August 2 from 5-7pm. The Burroughs Wellcome Gallery is open Monday through Friday from 8-5pm. For more information call (252) 328-1287.



## Upcoming Events

There are no upcoming events to display.

## View Calendar



## Central Piedmont / Seagrove Region Catalog



Sandy Cole Brown  
Sanford, NC



Ana King  
Seagrove, NC



Crystal King  
Seagrove, NC



Terry King  
Seagrove, NC



Stacy Lambert  
Clemmons, NC



Matt & Jennifer Luck  
Seagrove, NC



Jason Luck  
Seagrove, NC



Sid Luck  
Seagrove, NC



AV Smith  
Broadway, NC

## Central Piedmont / Seagrove Region Catalog



AV Smith  
Broadway, NC



ML Owen  
Seagrove, NC

## Catawba Valley Region Catalog



Steve Abee  
Lenoir, NC



Michael Ball  
Vale, NC



Michael Ball  
Vale, NC



Michel Bayne  
Lincolnton, NC



Burlon Craig  
Vale, NC



Don Craig  
Golden Valley, NC



Dwayne Craig  
Vale, NC



Hal Dedmond  
Lawndale, NC



Hal Dedmond  
Lawndale, NC

## Catawba Valley Region Catalog



Hal Dedmond  
Lawndale, NC



Kim Ellington  
Vale, NC



Walter Fleming  
Statesville, NC



Albert Hodge  
Vale, NC



Richard Kale  
Bandys, NC



Charlie Lisk  
Vale, NC



Charlie Lisk  
Vale, NC



Gary Mitchell  
Conover, NC



Joe Reinhardt  
Vale, NC

## Catawba Valley Region Catalog



Jeff Young  
Vale, NC



Jeff Young  
Vale, NC

## Mountain Region Catalog



Louis Brown  
Arden, NC

Back Row  
Charlie & Robert Brown  
Arden, NC

Lillie Brown  
Arden, NC

Christian Brown  
Arden, NC

Front Row  
Jeanette Brown  
Arden, NC

Charlie Brown Jr.  
Arden, NC



# Lee County High School Catalog



Sarah Batten  
Pottery 1, LCHS



Daniela Ocampo  
Pottery 1, LCHS



Carmen O'Quinn  
Pottery 1, LCHS



Micaela Schlott  
Pottery 1, LCHS



Samantha Sillaman  
Pottery 1, LCHS



Sara Smith  
Pottery 3, LCHS



Jody Stouffer  
Pottery Instructor, LCHS



Elijah West  
Pottery 1, LCHS



Legacy of the NC Face Jug Exhibit Inventory						
	Potter	Description of piece	Date	Dimensio	Value	From the Collection of
1	Abee, Steve	Swirl Face Jug with Snake	2008	11"	\$200	Brian Dedmond
2	Ball, Michael	Hear, Speak, See No Evil	2006	12"	\$300	Dawn Crouse
3	Ball, Michael	Stacker Face Jug	2011	10 1/2"	\$125	Brian Dedmond
4	Batten, Sarah	LCHS Student Face Jug	2013	6"	\$70	Sarah Batten
5	Bayne, Michel	Alkaline Face Jug	2012	18"	\$150	Michel Bayne
6	Brown Jr., Charlie	Red Brown Face Jug	1994	5 1/2"	\$300	Charlie Brown
7	Brown, Charlie	Double Face Jug #1 of 8	2002	16"	\$3,000	Charlie Brown
8	Brown, Christian	Red Brown Face Jug	1997	4 1/2"	\$300	Charlie Brown
9	Brown, Jeanette	Red Brown Face Jug	2006	7 1/2"	\$150	Charlie Brown
10	Brown, Lillie	Alakaline Glaze	1999	8"	\$500	Charlie Brown
11	Brown, Louis	Devil Face Jug	1991	15"	\$1,000	Charlie Brown
12	Cole, Sandy	Cat face Jug	2013	16"	\$125	Sandy Cole Brown
13	Craig, Burlon	Grey Swirl Face Jug	1990	13"	\$850	Crystal King
14	Craig, Don	Face Jug	2006	11"	\$175	Brian Dedmond
15	Craig, Dwayne	Devil Face Jug	2007	10"	\$175	Brian Dedmond
16	Dedmond, Hal	Indian Face Jug	2003	14"	\$125	Hal Dedmond
17	Dedmond, Hal	Triple Face Jug	2006	17"	\$215	Hal Dedmond
18	Dedmond, Hal	Hobgoblin Face Jug	2009	12"	\$125	Hal Dedmond
19	Ellington, Kim	Alkaline Face Jug	2009	14"	\$500	Brian Dedmond
20	Fleming, Walter	Alkaline Face Jug	2013	11"	\$150	Walter Fleming
21	Hodge, Albert	Devil Face Jug	2006	15"	\$350	Albert Hodge
22	Kale, Richard	Swirl Face Jug	1993	10"	\$150	Brian Dedmond
23	King, Ana	Betty Sue Girl Face Jug	2013	7"	\$125	Ana King
24	King, Crystal	Man's Conscience Face Jug	2013	8"	\$125	Crystal King
25	King, Terry	Howard the Face Jug	2013	16"	\$225	Terry King
26	Lambert, Stacy	Surrealistic Face Jug	2013	7"	\$75	Stacy Lambert
27	Lisk, Charlie	Swirl Face Jug	2000	14"	\$350	Charlie Lisk
28	Lisk, Charlie	Miniature Face Jug	2013	4"	\$40	Charlie Lisk
29	Luck, Jason	Face Jug	2013	8"	\$90	Sid Luck
30	Luck, Matt & Jennifer	Double Face Jug	2000	10"	\$300	Sid Luck
31	Luck, Sid	Face Jug	2013	13"	\$225	Sid Luck
32	Mitchell, Gary	Swirl Face Jug	2005	11"	\$100	Brian Dedmond
33	Ocampo, Daniela	Devil Face Jug	2012	5"	\$75	Daniela Ocampo
34	O'Quinn, Carmen	LCHS Gargoyle Face Jug	2013	5 1/2"	\$70	Carmen O'Quinn
35	Owen, ML	Face Jug	1983	9"	\$500	Boyd Owen
36	Reinhardt, Joe	Face Jug	2005	18"	\$200	Michel Bayne
37	Schlott, Micaela	LCHS Student Face Jug	2013	9"	\$70	Micaela Schlott
38	Sillaman, Samantha	LCHS Student Face Jug	2012	7"	\$70	Samantha Sillaman
39	Smith, AV	Red Face Jug	2012	10"	\$120	Savannah Stouffer
40	Smith, AV	Miniature Red Face Jug	2012	4"	\$40	Savannah Stouffer
41	Smith, Sara	Double Face Lamp	2011	14"	\$150	AV Smith
42	Stouffer, Jody	Face Jug	2012	10"	\$115	Jody Stouffer
43	West, Elijah	LCHS Student Face Jug	2013	5"	\$75	Elijah West
44	Young, Jeff	Alkaline Face Jug	2012	15"	\$200	Dawn Crouse
45	Young, Jeff	Pedastel Face Jug	2007	11 1/2"	\$120	Dawn Crouse

# Burroughs Wellcome Gallery Schematic

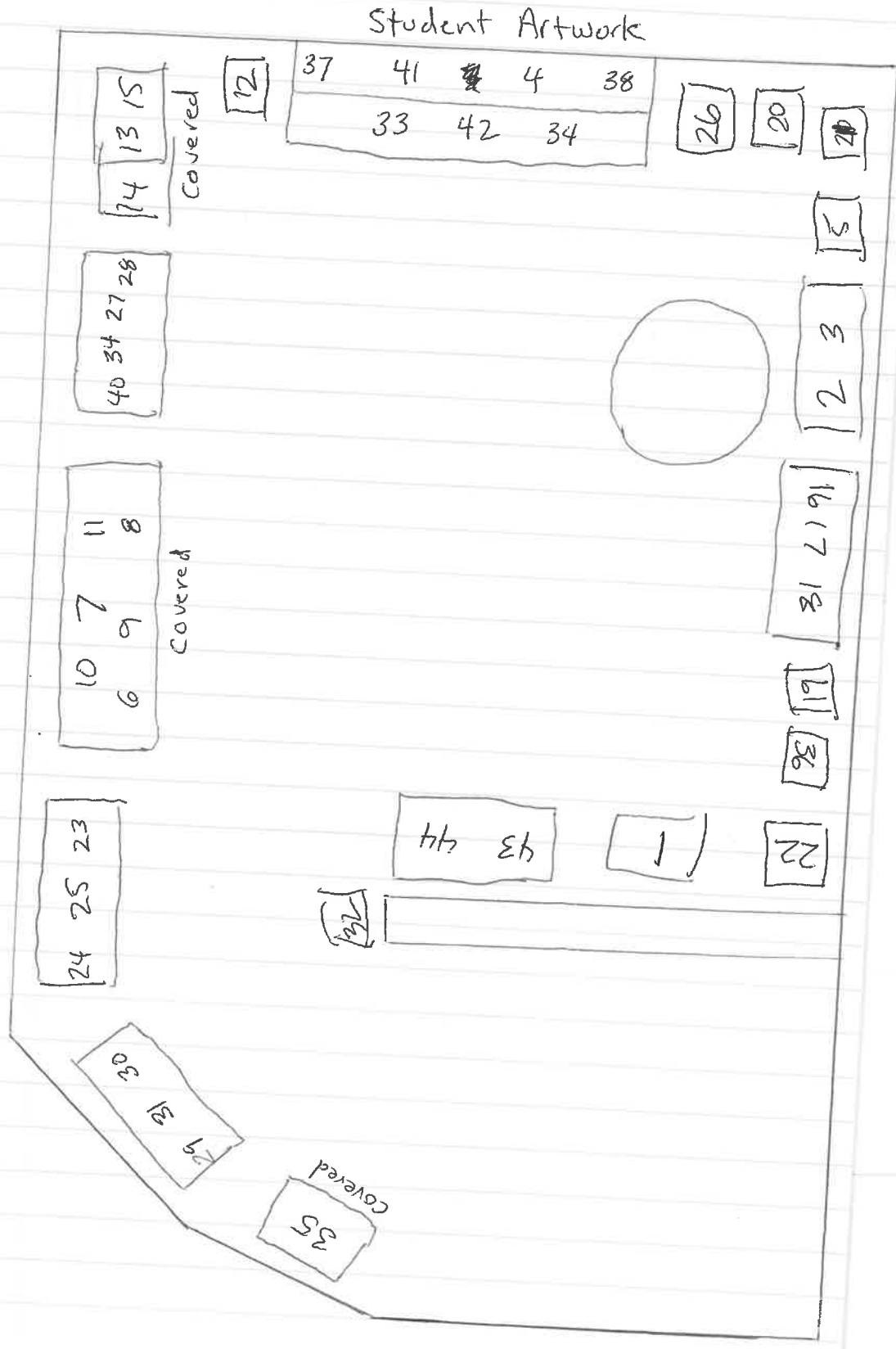



# Legacy of the North Carolina Face Jug Exhibit





## Legacy of the North Carolina Face Jug Reception







## FROM ONE LUMP OF CLAY...

Luck's Ware continues the ancient art of wheel-thrown pottery near Seagrove, the "Pottery Capitol" of North Carolina. Visitors can experience the entire process from the mixing of the clay to the finished ware. Sid Luck has always been a part of this tradition. As a fifth generation potter, he has continued to turn the shapes of his ancestors. At the early age of 12, he was turning pots for J.B. Cole Pottery. He continued turning pots on a part-time basis during his years in the U.S. Marine Corps, while attaining his degree in chemistry at N.C. State University and during his career as a teacher in public schools. In 1987 he opened his own pottery shop parttime. In 1990 his attraction to clay won, and he resigned from teaching to open Luck's Ware as a full-time business.

Sid is committed to continuing the pottery tradition of his ancestors. This tradition is observed in the shape of many old time functional pieces such as candleholders, churns, jugs, and pitchers. He digs local clay to use in some of his pottery. One of the wheels he still uses for turning was originally in his father's shop, just down the road.



CENTERING • MAKING A CONE • PULLING THE CLAY • FINISHING THE PIECE

*Sid Luck - Living Treasure of North Carolina - 1994*



## SALT-GLAZED WARE:

Luck's Ware salt-glazed pottery is fired in a groundhog kiln built in 2003. Bricks from the kilns of Sid's father and grandfather were used in the construction. Pottery is fired with wood over a period of about 15 hours, culminating in salt being introduced into the firing about an hour before the end of the firing.

## STONEWARE:

Luck's Ware pottery is traditional, lead-free, utilitarian stoneware fired to a temperature of 2200 degrees (F.). It is suitable for use in conventional or microwave ovens and is dishwasher safe. This pottery is as visually appealing as it is functional, with its wide array of colorful glazes and graceful forms.

*"Potters at work" Left to right: Debbie - Jason - Matt - Sid*



---

# *Brown's Pottery 9 Generations of Potters*

---

*showroom located  
in Arden, NC  
at the intersection of  
Buck Shoals Road and  
2398 Hendersonville Road  
Box 10, Arden, NC 28704*

Specializing in:  
Cookware  
Face Jugs

9 Generations  
(528) 684-2901

**Brown's Pottery**

A Southern Traditional Pottery  
[www.browns pottery.com](http://www.browns pottery.com)

CHARLIE & JEANNETTE - 8th Generation  
LIL' CHARLIE & CHRISTIAN - 9th Generation

Highway 25  
P.O. Box 10  
Arden, NC 28704

## **Face Jugs - ugly or voodoo jugs**

*In days of yore, all through the Appalachian Mountains and in South Carolina, when someone died, a Devil Face Jug would be placed on the grave. After one year, if the jug was broken, the person's soul was presumed to be wrestling with the devil. If the jug was not broken, then the soul was presumed resting happily ever after. Among the people of this culture, many other humanoid face jug creations developed. These face jugs were used in the 1900's for liquor vessels. Some of our more popular styles are,*

### **Buggy Jugs**

*In horse and buggy days, the squatty wide jugs were concealed from the sheriff under the Missus' apron.*

### **Dunks Jugs**

*"Our Southern Pride" was developed by Grandpa. The many handles provide a drunk a handle, no matter how drunk he was.*

### **Monkey Jugs**

*The jug with many spouts. One for the master to drink from, one for the slave.*

### **Chicken Waterer**

*For the chickens to be fed and watered from.*

### **1997**

- Louis Davis Brown (L.D.B.) 72 years old, son of the late Davis P. Brown
- Lillie Butler Brown (L.B.B.) Wife of Louis Brown
- Charles Davis Brown (C.D.B.) son of Louis & Lillie Brown
- Jeannette Bradley (J.B.B.) Wife of Charles D. Brown

### **9th Generation Beginners**

**Little Charlie & Christian Brown, sons of Charlie & Jeannette**

## Legacy of the North Carolina Face Jug Final Thoughts

Looking back over the last two years, it seems befitting that my final culminating project would be an exploration into the mystical realm of folk art face jugs. I consider myself very privileged to have been mentored by professors who have kept my learning student centered and have allowed me the independence to integrate my interest of southeastern ceramics with their curriculum.

When I started work in the ECU Master's program in the spring of 2011, I had just taken over the ceramics classes at Lee County High School and was anxious to provide my students with a deeper learning experience then just simply making clay pots. The pairing seemed almost meant to be when for my second Master's class I was enrolled in Professor Duffy's *Ceramic History of North Carolina and the Southeastern United States*. At the conclusion of this course, I couldn't believe how much I had learned about North Carolina ceramics during the short nine week summer session class. The class was probably one of the most demanding that I would take during my degree work, but I learned a ton and was able to provide my students a more balanced ceramics experience learning about not only the technical skills involved in making pottery but also the historical significance, particularly to our state. In taking this class, it added gas to my fire of interest in North Carolina ceramics, particularly North Carolina folk art pottery.

In teaching, I am drawn to emphasize the importance of ceramics in our state because of the deep cultural roots that connect North Carolina with pottery and are known world wide. Later in my Master's classes, Dr. Malley encouraged me to follow my interests and for his final project, I submitted an in depth examination of southern folk art face jugs entitled *The Origins*



*and Uses of the Southern Folk Art Face Jug*. The final piece was 27 pages long and I thoroughly enjoyed the challenges of researching this topic because much of the face jug heritage has been passed down through storytelling and discovering facts was much like trying to solve a mystery. As I documented my findings I was excited to learn that although there are several books that mention face jugs, there are only a couple that devote the entire book to this folk art and even those are very vague in investigating the origins of the face jug. A few semesters later, Dr. Bickley-Green's *Research in Art Education* would provide another opportunity for exploration. For the project in her class, I intended to interview 20 face jug potters throughout the state, learning about their introduction to face jugs, their inspirations and why as contemporary potters they continue to create this traditional folk art form. Dr. Bickley-Green was excited about this notion but thought that it was a bit too ambitious and encouraged me to simply focus that idea on one face jug potter. Following her advice, I created a research project where I would interview AV Smith, a local face jug potter and document him creating a face jug while learning more about the history of this art form and why contemporary potters today still continue to create this grotesque vessel.

As I approached my final project, I truly felt that completion of my paper from Dr. Malley's class into book form was going to be the route that I would go. However after reading the text, *Valley Ablaze*, a book published last fall that focuses on the face jug potters of the Catawba Valley Region in North Carolina, I realized that the time I would need to invest in completing this project properly would extend well beyond the time allocations that I would have for my final project. I then decided to revisit my idea from Dr. Bickley-Green's course, showcasing the state's face jug potters through an exhibition, *The Legacy of the North Carolina Face Jug Exhibit*.

From the beginning, I felt very passionate about this project. I felt that I had laid a strong foundation through my previous research and this exhibit would provide the perfect cap stone to my Master's degree learning as well as my focus on folk art pottery. Much of the information collected during my research of AV Smith provided the perfect starting point and allowed me to create promotional materials fairly easily as well as have a good angle towards approaching other potters in inviting them to participate in this exhibit. My past experiences with the pottery community provided reassurance that many of the potters would be thrilled to participate and my intuition of this was true, all that were invited agreed to contribute. My summer months were now consumed with finalizing the promotional materials, setting up dates for collection of the pottery, contacting media outlets, promoting the exhibit throughout the state and collecting the pottery. The hidden gem during this project was the interaction with the potters and getting to hear their personal stories that connected themselves with their creations. The acquaintances I made will prove to be very valuable when I continue to work on my book. One particularly good discovery was the link I made with Seagrove face jug potter, Crystal King, who asked to read my findings so far on face jugs and was so impressed with my research that she offered to collaborate with me on my book. Being a second generation face jug potter, she provides a great entry into the face jug community, as her family is well known throughout the south by many of the face jug creators.

In retrospect, my only reservations about this project are that I wish the exhibit would have run during a time when more people would have been on campus to enjoy it. I also would have liked further time to have created a more in depth experience for the patrons by providing more extensive background about the potters, the regions they represent and the pieces on

exhibit through display boards or an exhibit catalog. Over all, I am very pleased with the outcome of this exhibit, I am excited that I was able to put together one of the best and most in depth North Carolina face jug exhibitions up to date according to the patrons that I've interacted with. I now look forward to building upon this experience by continuing my work towards publishing my book, *The Origins and Uses of the Southern Folk Art Face Jug*.